

PALOMINO FIELDS PLAT - DIVISION III
A REPLAT OF TRACT 'A', PALOMINO FIELDS PLAT - DIVISION II
A PORTION OF THE S ½ OF THE NW ¼ OF SECTION 27, TOWNSHIP 18 NORTH, RANGE 18 EAST, W.M.
KITITAS COUNTY, WASHINGTON

ORIGINAL
PROPERTY DESCRIPTION
Tract 'A' of the Palomino Fields Plat - Division II as recorded in Book 13 of Plats, Pages 23 through 29, as recorded under the Kittitas County Auditor's File Number 201905210014.

DEDICATIONS

DEDICATION KNOW ALL MEN by these presents, CLE ELUM PINES WEST, LLC, a Washington Limited Liability Company, do hereby declare this plat and dedicate to the public forever all roads and ways hereon with the right to make all necessary slopes for cuts and fills, and the right to continue to drain said roads and ways over and across any lot or lots, where water might take a natural course, in the original reasonable grading of the roads and ways shown hereon. Following original reasonable grading of roads and ways hereon no drainage water on any lot or lots shall be diverted or blocked from their natural course so as to discharge upon any public road rights-of-way, or to hamper proper road drainage. Any enclosing of drainage waters in culverts or drains or rerouting thereof across any lot as may be undertaken by or for the owner of any lot, shall be done by and at the expense of such owner.

IN WITNESS WHEREOF, we have hereunto set our hands and seal this day of..... A.D., 2020, CLE ELUM PINE WEST, LLC., A Washington Limited Liability Company

President
CLE ELUM PINES WEST, LLC

ACKNOWLEDGEMENTS

STATE OF WASHINGTON)
COUNTY OF) SS

On this day of A.D., 2020, before me, the undersigned, a Notary Public in and for the State of Washington, duly commissioned and sworn, personally appeared and, to me known to be the president of CLE ELUM PINE WEST, LLC, and acknowledged the said instrument, for the uses and purposes therein mentioned, and on oath stated that he (she) was authorized to execute the said instrument and that the seal affixed is the corporate seal of Said Corporation.

WITNESS My hand and official seal the day and year first written.

Notary Public in and for the State of Washington,
residing at

GENERAL NOTES

1. As per RCW 17.10.140, landowners are responsible for controlling and preventing the spread of noxious weeds. Accordingly, the Kittitas County Noxious Weed Board recommends immediate reseeding of areas disturbed development to preclude the proliferation of noxious weeds.
2. Construction of access improvements will require obtaining an access permit from the Department of Public Works. All access improvements shall be completed in accordance with current Kittitas County Road standards prior to issuance of a building occupancy permit for any proposed lots.

DEDICATION KNOW ALL MEN by these presents, CLE ELUM PINES EAST, LLC, a Washington Limited Liability Company, do hereby declare this plat and dedicate to the public forever all roads and ways hereon with the right to make all necessary slopes for cuts and fills, and the right to continue to drain said roads and ways over and across any lot or lots, where water might take a natural course, in the original reasonable grading of the roads and ways shown hereon. Following original reasonable grading of roads and ways hereon no drainage water on any lot or lots shall be diverted or blocked from their natural course so as to discharge upon any public road rights-of-way, or to hamper proper road drainage. Any enclosing of drainage waters in culverts or drains or rerouting thereof across any lot as may be undertaken by or for the owner of any lot, shall be done by and at the expense of such owner.

IN WITNESS WHEREOF, we have hereunto set our hands and seal this day of..... A.D., 2020, CLE ELUM PINE EAST, LLC., A Washington Limited Liability Company

President
CLE ELUM PINES EAST, LLC

WATER NOTES
On February 8, 2017 Chicago Title and Ellensburg Water Company were contacted to find any information regarding the location and ownership of the "Town Ditch". At that time both entities were unable to provide any information to said ditch. The Ellensburg Water Company believes there is at least a prescriptive easement for said ditch but we do not have any documentation to prove this or even define said ditch other than the surveyed location shown on this survey.

NOTICE

This is a Major Plat and as such is not intended to show, nor does it purport to show, all easements and encumbrances.

STATE OF WASHINGTON)
COUNTY OF) SS

On this day of A.D., 2020, before me, the undersigned, a Notary Public in and for the State of Washington, duly commissioned and sworn, personally appeared and, to me known to be the president of CLE ELUM PINE EAST, LLC, and acknowledged the said instrument, for the uses and purposes therein mentioned, and on oath stated that he (she) was authorized to execute the said instrument and that the seal affixed is the corporate seal of Said Corporation.

WITNESS My hand and official seal the day and year first written.

Notary Public in and for the State of Washington,
residing at

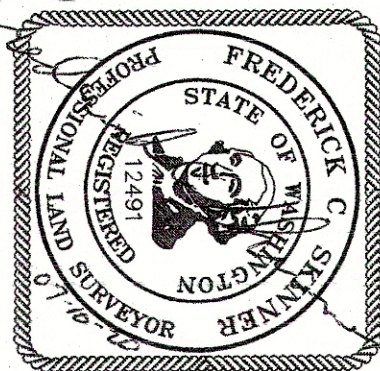

| | | | | | | | | | | | | | | | | | | | | | | | | | | | | |
|---|--|---|--|--|--|--|--|--|--|--|--|--|--|--|--|--|--|--|--|--|--|--|--|--|--|--|--|--|
| INSTRUMENT USED | | INDEXING DATA | | | | | | | | | | | | | | | | | | | | | | | | | | |
| Trimble R10 GPS Receivers | | <table><tr><td></td><td></td><td></td><td></td><td></td></tr><tr><td></td><td></td><td></td><td></td><td></td></tr><tr><td></td><td></td><td></td><td></td><td></td></tr><tr><td></td><td></td><td></td><td></td><td></td></tr><tr><td></td><td></td><td></td><td></td><td></td></tr></table> | | | | | | | | | | | | | | | | | | | | | | | | | | |
| | | | | | | | | | | | | | | | | | | | | | | | | | | | | |
| | | | | | | | | | | | | | | | | | | | | | | | | | | | | |
| | | | | | | | | | | | | | | | | | | | | | | | | | | | | |
| | | | | | | | | | | | | | | | | | | | | | | | | | | | | |
| | | | | | | | | | | | | | | | | | | | | | | | | | | | | |
| Traverse Closure Meets Standards Per WAC 332-130-090 | | S27 T18N R18E | | | | | | | | | | | | | | | | | | | | | | | | | | |
| | | | | | | | | | | | | | | | | | | | | | | | | | | | | |
| WESTERN PACIFIC ENGINEERING & SURVEY | | | | | | | | | | | | | | | | | | | | | | | | | | | | |
| A TERRA DEVELOPMENT SERVICES CORPORATION 1328 E. Hunter Place, Moses Lake, Washington T:(509)765-1023 F:(509)765-1298 Services in Washington and Idaho | | | | | | | | | | | | | | | | | | | | | | | | | | | | |
| Surveyed by LMH | | Scale 1" = N/A | | | | | | | | | | | | | | | | | | | | | | | | | | |
| Drawn by Tml/FCS | | Sheet 5 of 5 | | | | | | | | | | | | | | | | | | | | | | | | | | |
| Checked by | | Project No. 18146 | | | | | | | | | | | | | | | | | | | | | | | | | | |
| LCU, INC. | | | | | | | | | | | | | | | | | | | | | | | | | | | | |